

CO₂MMANDER® Elite

Portable delivery system for Medical-Grade CO₂

CO₂MMANDER® Elite

The CO₂MMANDER® Elite is a portable, compact medical-grade CO₂ delivery system. No external power or gas supply is required. The device uses small medical-grade CO₂ cartridges which deliver pressure controlled gas at the press of a button. The CO₂MMANDER® Elite allows all the safety and benefits of CO₂ in a portable system.

The CO₂MMANDER® Elite is very simple to operate and comes with a QuickStart guide which provides instruction on engaging and disengaging the device. The AngiAssist medical gas management system is user-friendly, safe and offers accurate pressure controlled gas.

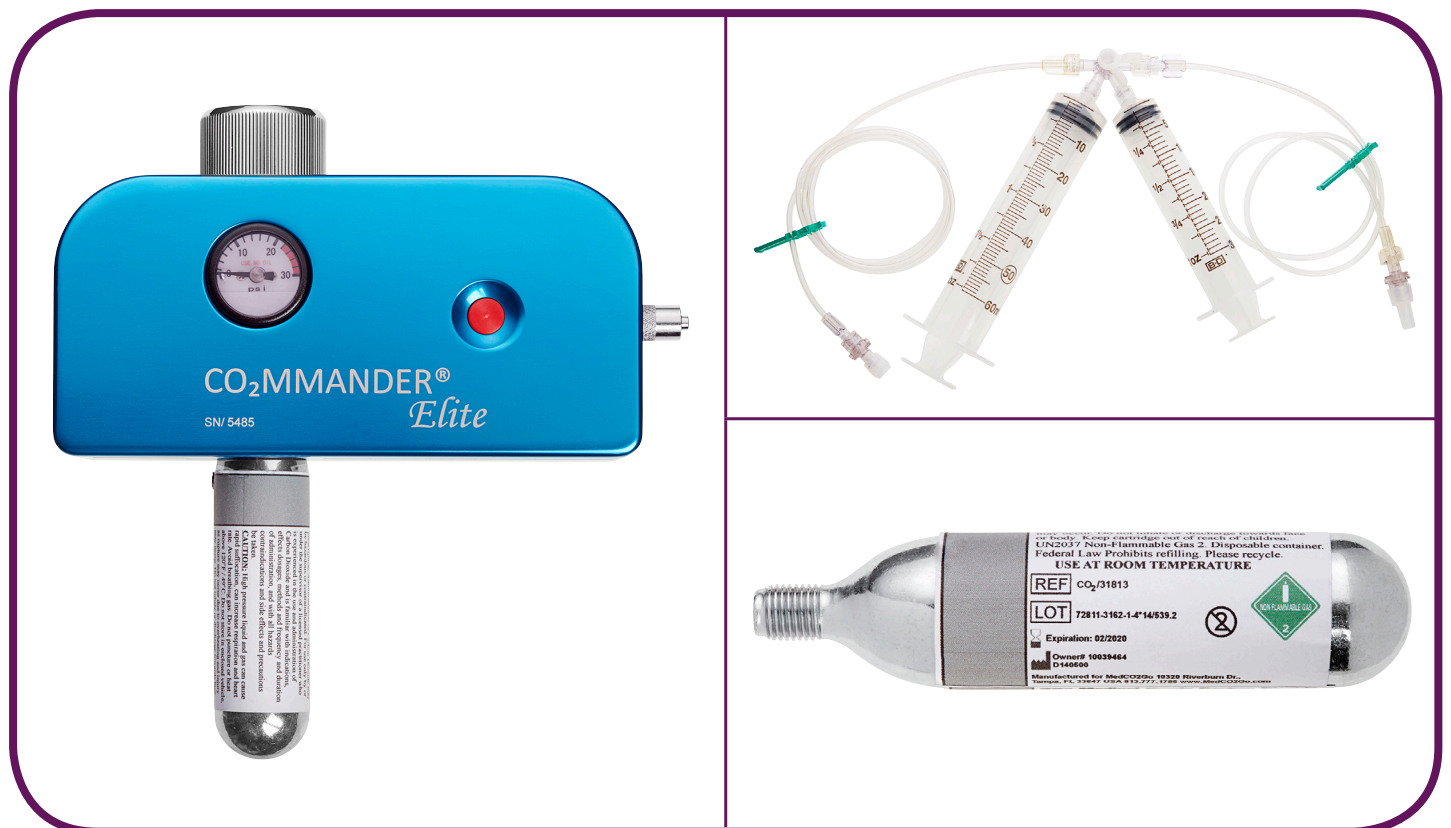

CO₂MMANDER® Elite

Portable delivery system for Medical-Grade CO₂

CO₂MMANDER® Elite

Safe for the patient

Device is more user-friendly for wider acceptance

Cost reduction to end-user

Eliminates explosive delivery issues

More defined delivery flow

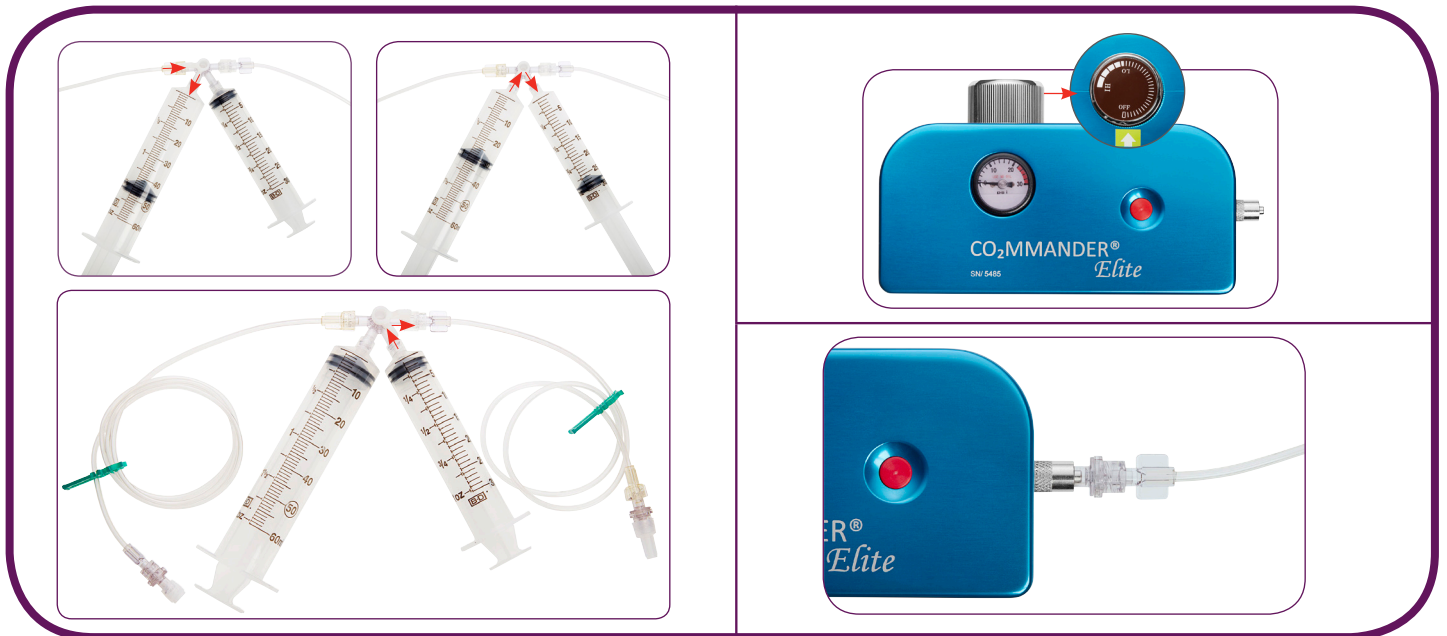

Products No.	Products Name	Qty/box
COM12	CO2MMANDER® Elite - CO ₂ Delivery System	1
AA0608	AngiAssist® - Medical Gas Management System	10
CO2/31813	Medical Grade CO ₂ Cartridge	3